

Smart Meter

DTSU666

Three-phase smart meter DTSU666 has been designed especially to measure PV system power generation and system demand. 3rd-party CTs can be connected to the meter according to the requirements for the installation. Using RS485 communication, any CSI three-phase inverter can be connected to the DTSU666, enabling export limit functionality. With a wide detectable range of voltage and current, it is the ultimate cost-saving solution for PV systems with large load consumptions.



Manufacturer: CHINT

KEY FEATURES

- **Measurement function: Accurately measure voltage, current, power, frequency, electrical energy and power factor**
- **Display function: LCD display function, supporting switching with buttons**
- **Communication function: RS485 communication interface, supporting Modbus RTU protocol**
- **Refresh rate: active power less than 100ms**

Appearance and Dimensions

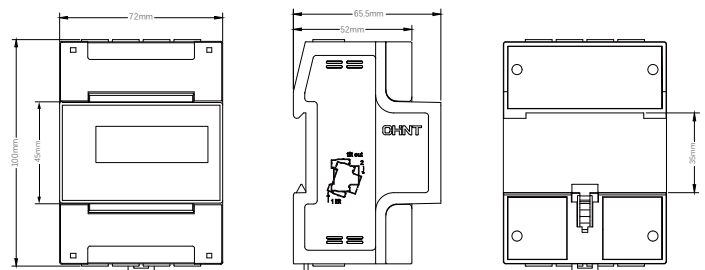

CSI Solar Co., Ltd. is committed to providing high quality solar products, solar system solutions and services to customers around the world. Canadian Solar was recognized as the No. 1 module supplier for quality and performance/price ratio in the IHS Module Customer Insight Survey, and is a leading PV project developer and manufacturer of solar modules, with over 63 GW deployed around the world since 2001.

Technical parameters

Measurement accuracy	Voltage	$\pm 0.5\%$
	Current/power	$\pm 1\%$
	Electric energy	$\pm 1\%$
Electrical parameters	Grid type	Three phase four wire system (3P4W)
	Voltage specifications	$3 \times 230/400V$
	Current specifications	1.5(6)A
	Specified working voltage range	207V ~ 253V(phase voltage)
	Extended operating voltage range	184V ~ 264V(phase voltage)
Communication	Communication interface	RS485
	Communication protocol	Modbus RTU protocol
	Baud rate	1200/2400/4800/9600bps (default)
Environment	Specified operating temperature range	$-25^{\circ}C \sim +55^{\circ}C$
	Extreme operating temperature range	$-40^{\circ}C \sim +70^{\circ}C$
	Relative humidity (non-condensing)	$\leq 75\%$
	Atmospheric pressure	86kPa ~ 106kPa
Specifications	Dimensions	72mm \times 100mm \times 65.5mm (tolerance ± 1 mm)
	Installation type	DIN35mm rail mounted

Wiring drawings

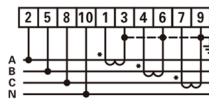
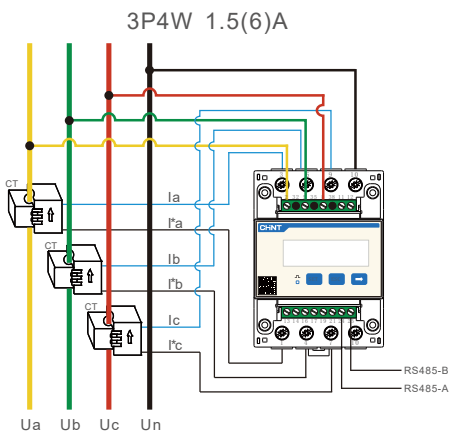

Upper row terminal

Transformer connection			Voltage input				Free				
Ia	Ib	Ic	Ua	Ub	Uc	N	N/A				
3	6	9	2	5	8	10	11	12	32	35	38

Lower terminal

Transformer connection			Free							Communication	
I'a	I'b	I'c	N/A							RS485-A	RS485-B
1	4	7	10	13	14	16	17	19	21	24	25